



- Polyamide hand held enclosure for MCR- and automation engineering
- Ergonomic enclosure shape
- Version with or without display opening
- Prepared for acceptance of keypads/silicone switch mats
- Optional EMC version with internal coating and EMC seal

Included in delivery

Double-skinned enclosure with top and base unit, each with fixing domes, mounting / hook set, fastening and enclosure screws.

Technical data

Material:

polyamide

Ingress protection:

IP 65 to EN 60529

Surface resistance:

10^{12} Ohm, IEC 60093

Flammability:

V2 / UL 94

Colour:

RAL 7021, black grey

Temperature range:

-40°C to +60°C

Beluga 380

Programme range

Enclosure type	Order No.	Version	Dimension W x L x H (mm)	Weight (kg)
Beluga 380	27.02 05 01	closed	380 x 117 x 68	0.52

Accessories

Cable gland with bending protection M 16 x 1,5	08.10 01 16
Cable gland with bending protection M 20 x 1,5	08.10 01 20
Carrying strap	27.02 05 80
Hand strap	27.02 05 81
Wall holder	27.02 05 82
Spare screws	27.02 05 83
Push-button and switches see page 53 - 58	on request



Wall fixing set

stainless steel angle bracket set, +/- 45° inclination slope adjustable by means of knurled screws.

Order No. **27.02 05 82**

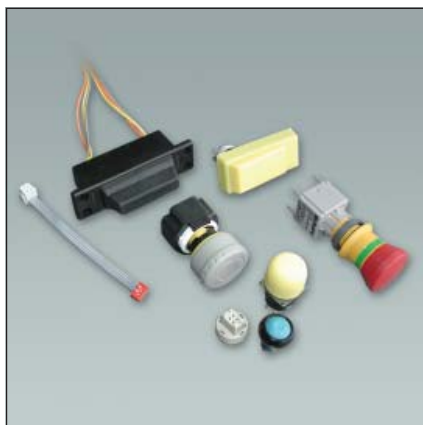

Electromechanical components

On request, we can supply equipment fitted with electro-mechanical components such as emergency stop button, acknowledge keys, hand wheel, switches, display

Component mounting options

Component options	Type B380
Display (max. view area / max. mounting dimensions see drawing on page 53 - 58)	•
Emergency stop button	•
Confirm key	•
Enabling switch	•
Hand wheel	•
Step switch	•
Joy stick	•
Cable outlet up to M 20	•
1st board (main board)	•
Other boards	•

Dimensions



Order No. 27.02 05 01

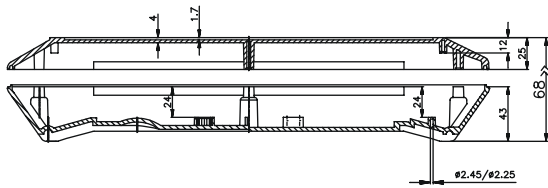
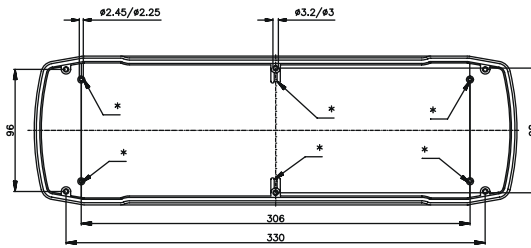
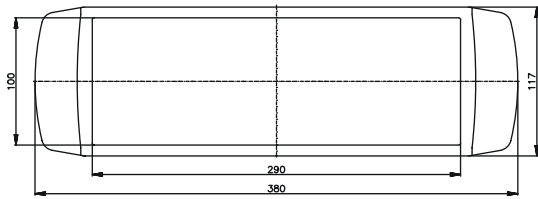
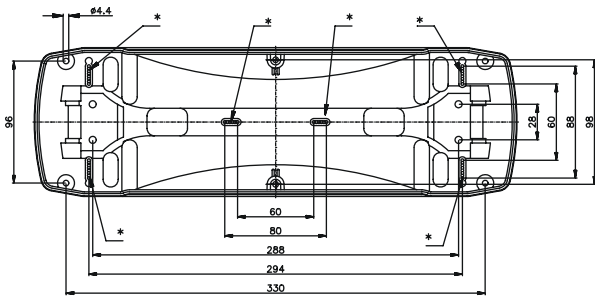
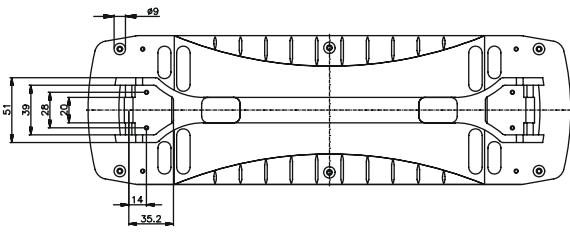

* = PCB mounting boss (screw 3 x 8)



Large displays mounted (1/4 VGA)



Integrated hook set



Large mounting space for electronic devices



Hook set, can be used as a stand